

# CLOUD-BASED WEB-TO-PRINT STOREFRONTS



Advanced W2P services that are flexible, integrated, mobile and comparable to systems costing much more.



WHY CHOOSE  
 **PRESSERO™** ?



CANON SEE IMPOSSIBLE

# CAPABILITIES & CONNECTIVITY

A cloud-based B2B and B2C online storefront solution easily customized to individual client and market needs. Sell printing of all kinds. Online design (eDocBuilder is included), instant pricing, reorders, inventory fulfillment, shipping integration (UPS, FedEx, etc.), and credit card payments are all supported. It supports integration with a wide variety of 3rd party software such as imposition, preflight, workflow management and MIS/estimating software. (Optional add-ons).

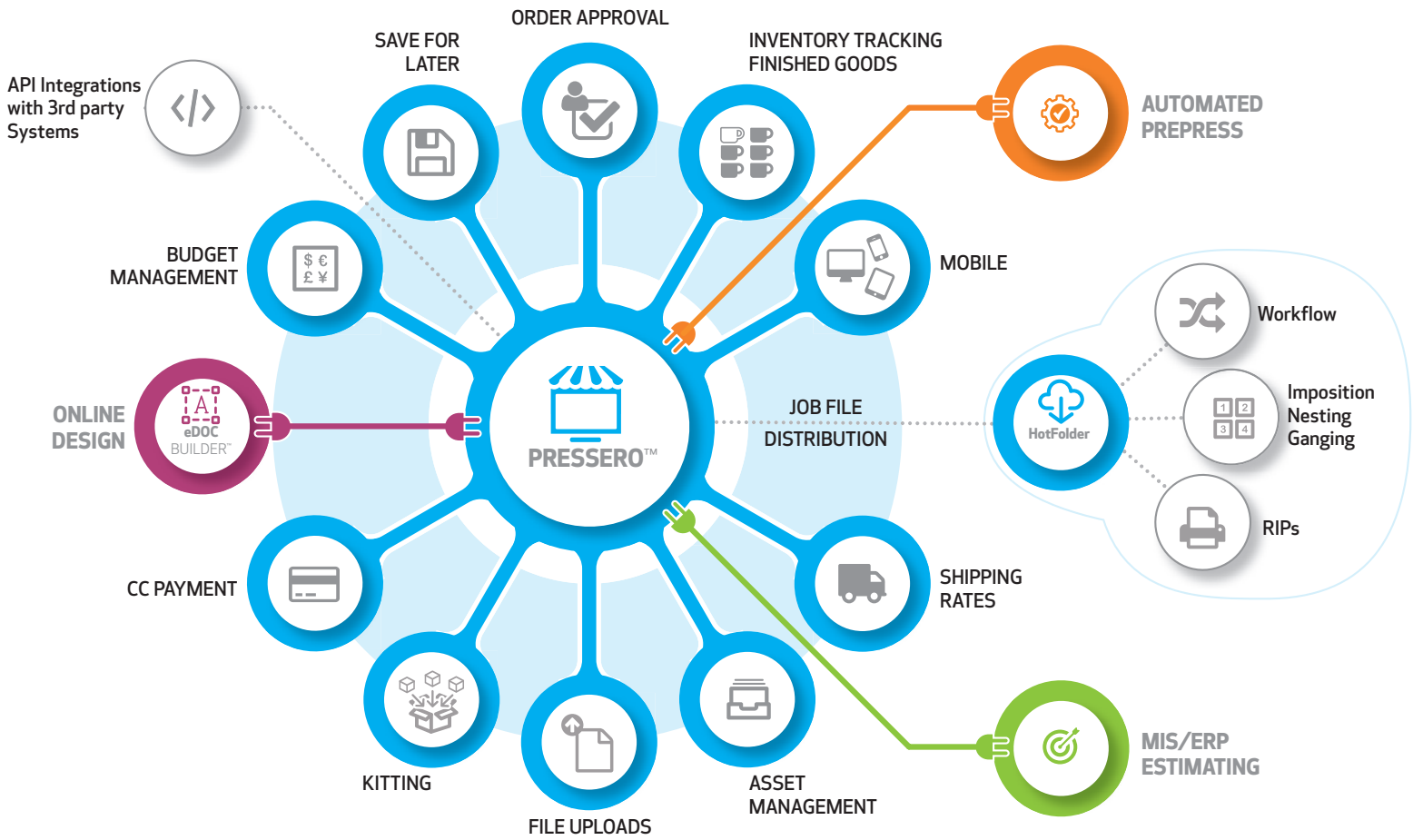

- Features vary based on plan
- Connected Aleyant Online Design Workflow (included)
- Connected Aleyant MIS/ERP Workflow option
- Connected Aleyant Prepress Workflow option
- 3rd Party Integration options

## KEY FEATURES

- Move
- Undo / Redo
- Edit text / font
- Crop Image
- Rotate
- Scale
- Multilayer

N<sub>1</sub>-N<sub>2</sub>... Variable Data

Automates prepress and manages variable data with incredible ease



Create B2B and B2C online stores adapted and customized to your needs and those of your customers



# Pressero B2B

Dedicated "big business" accounts

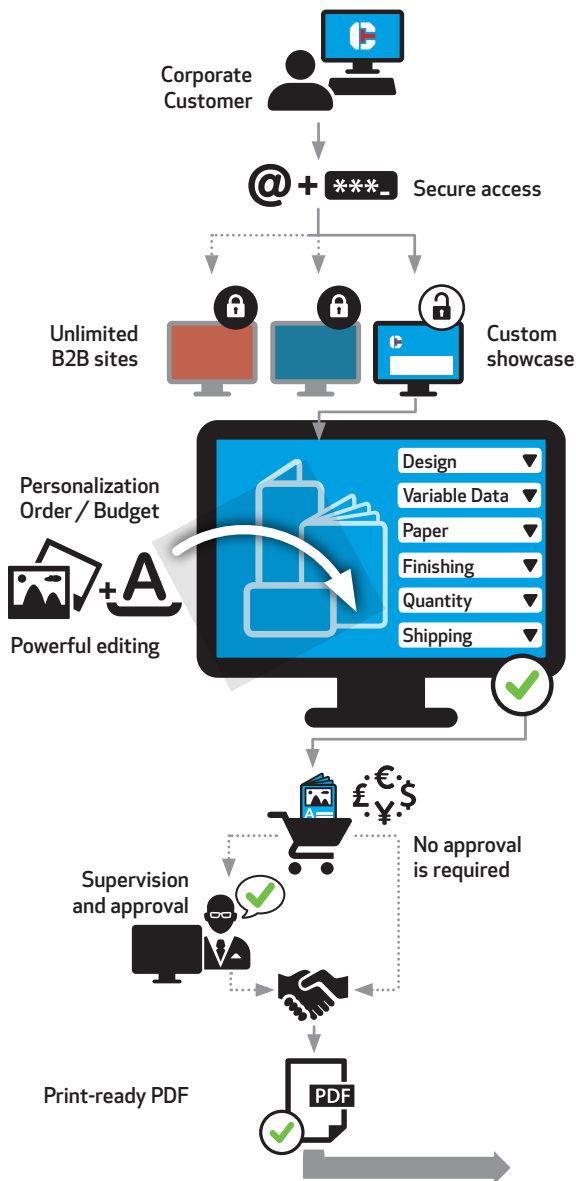

# Pressero B2C

Public stores for niche or general markets

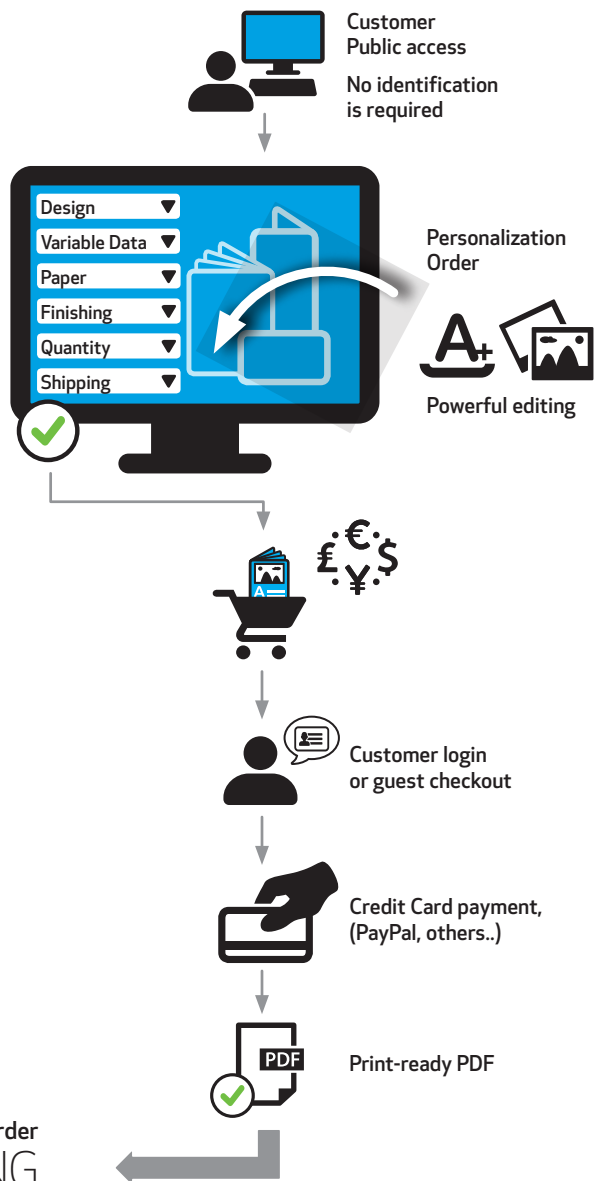

On receipt of order  
**PRINTING**

STOREFRONTS

ADMINISTRATION

PRINT AND DELIVERY

**New order received!**  
You (or your print vendor) are notified of the new order. The generated PDF is ready to print.

**Printing and delivery**  
The job is printed and delivered through the shipping method selected by the customer.

**Pressero administration**  
One person can quickly and reliably manage orders.

- Notifications and reports
- Job status
- Order history
- External suppliers
- Stock control and inventory

**Pressero grows with you**  
Integration options enable you to increase your productivity and make your work easier as needs grow.

- Imposition
- Preflight and color management
- Workflow API/XML (Web Services)
- MIS/ERP
- Scheduling





## USE PRESSERO TO ITS FULL POTENTIAL WITH PROFESSIONAL SERVICES FROM CANON SOLUTIONS AMERICA

Whether your business is large or small, remaining competitive in the global economy means you need to concentrate on what makes you successful—your core business. When selecting and implementing new technology, a highly skilled technical team makes the difference for a successful deployment.

Canon Solutions America has the team of experts you need to help you acquire the right technology, solutions, and services for your organization.

From pre-sales analysis to post-sales support, our team of technical professionals draws upon decades of technical expertise and real-world experience to ensure you obtain the maximum benefit from your technology investment.

# Canon

CANON SOLUTIONS AMERICA

For more information, call or visit  
**1-800-815-4000** [CSA.CANON.COM](http://CSA.CANON.COM)